

REV. NO.	DATE	DESCRIPTION
1	06/24/2021	CRANSE CORDER NO. 1

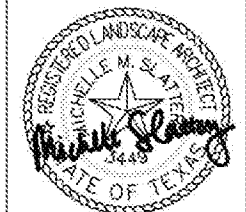

06/24/2021

CITY OF AUSTIN, TEXAS
 AUSTIN TRANSPORTATION
 AIM SOUTH LAMAR C1
 RIVERSIDE DR TO BARTON SPRINGS RD
 PLAN ENLARGEMENT
 SE CORNER AT BARTON SPRINGS RD

CITY OF AUSTIN
austin
MOTION
 2016 MOBILITY BOND

NOTES	NAME	DATE
SURVEY BY		
DRAWN BY	BE	06/24/2021
DESIGNED BY	MS	05/24/2021
CHECKED BY	JM	06/24/2021
REVIEWED BY	JA	06/24/2021

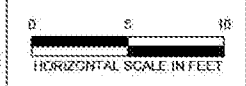

SP-2020-0084D

- LEGEND:**
- IMPROVEMENTS BY OTHERS
 - EXISTING IMPROVEMENTS IN ROW TO REMAIN
 - PLANTING AREA (SEE L3.0 - L3.9)
 - PROPOSED CONCRETE PAVER UNITS (COA Bid Item 480SNS)
 - PROPOSED MORTARED RIVER ROCK (COA Bid Item SP434S-MRR)
 - PROPOSED EXPOSED AGGREGATE CONCRETE PAVING (Bid Item SS321313.13)
 - PROPOSED CONCRETE PAD FOR CAP METRO BUS STOP (COA Bid Item 432S-5)
 - PROPOSED SIDEWALK (COA Bid Item 432S-5)
 - PROPOSED BIKE LANE AND SHARED-USE PATH (COA Bid Item SP432S-SUP)
 - LITTER BINS (TRIO - LANDFILL, RECYCLING, COMPOST) (SEE L2.5, Bid Item SS129300)
 - BIKE RACK (SEE L2.6 & L2.7)
 - PROPERTY LINE
 - LIMIT OF CONSTRUCTION
- DIMENSIONS:**
 CIVIL AND UTILITY ELEMENTS ARE SHOWN FOR REFERENCE ONLY: SEE ACTUAL CIVIL AND UTILITY PLANS FOR FINAL LOCATION, DIMENSIONS, AND GRADING.

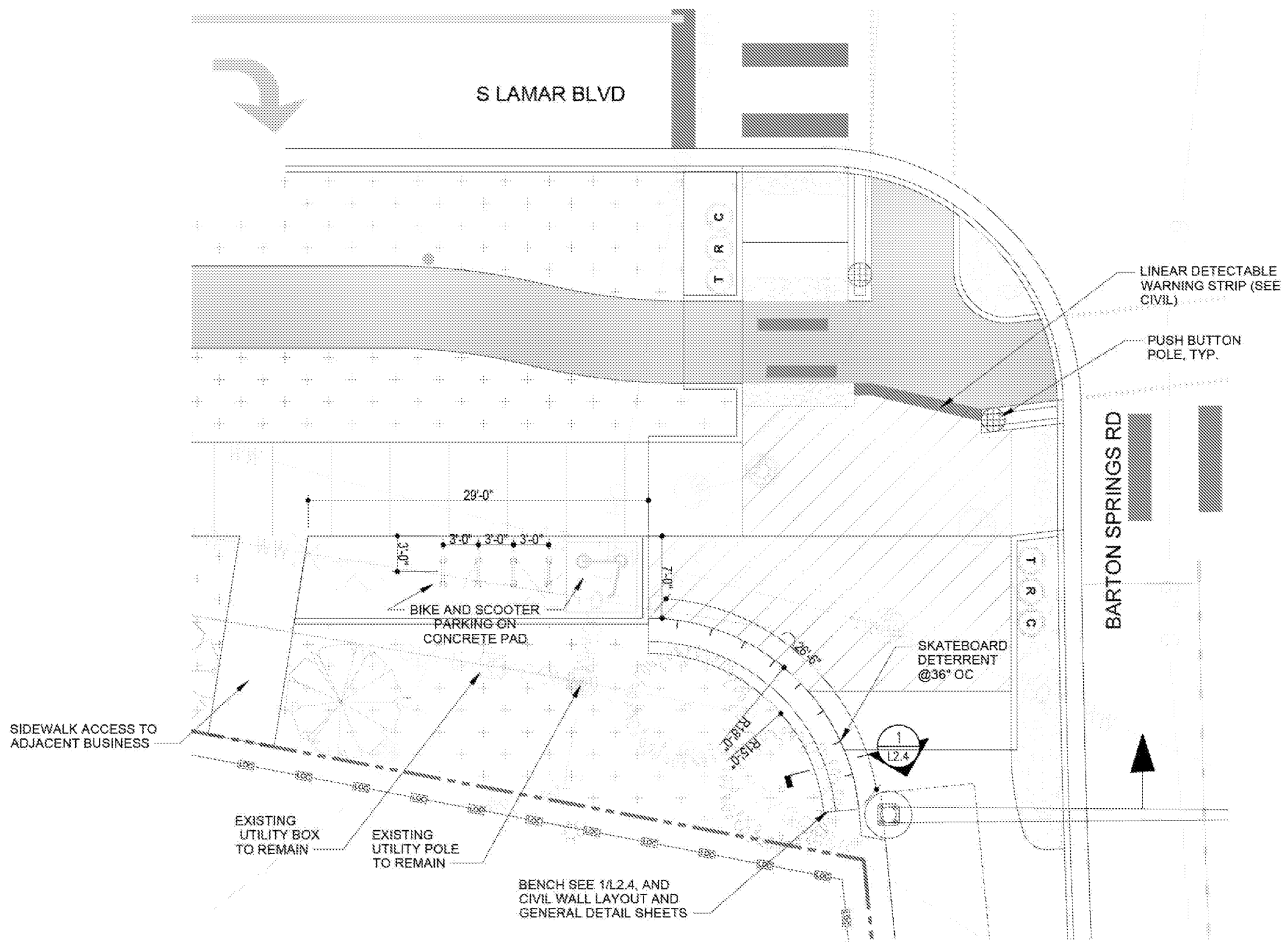

1 ENLARGED PLAN AT McDONALD'S
 SCALE: 1" = 10'-0"

