

A

B

C

D

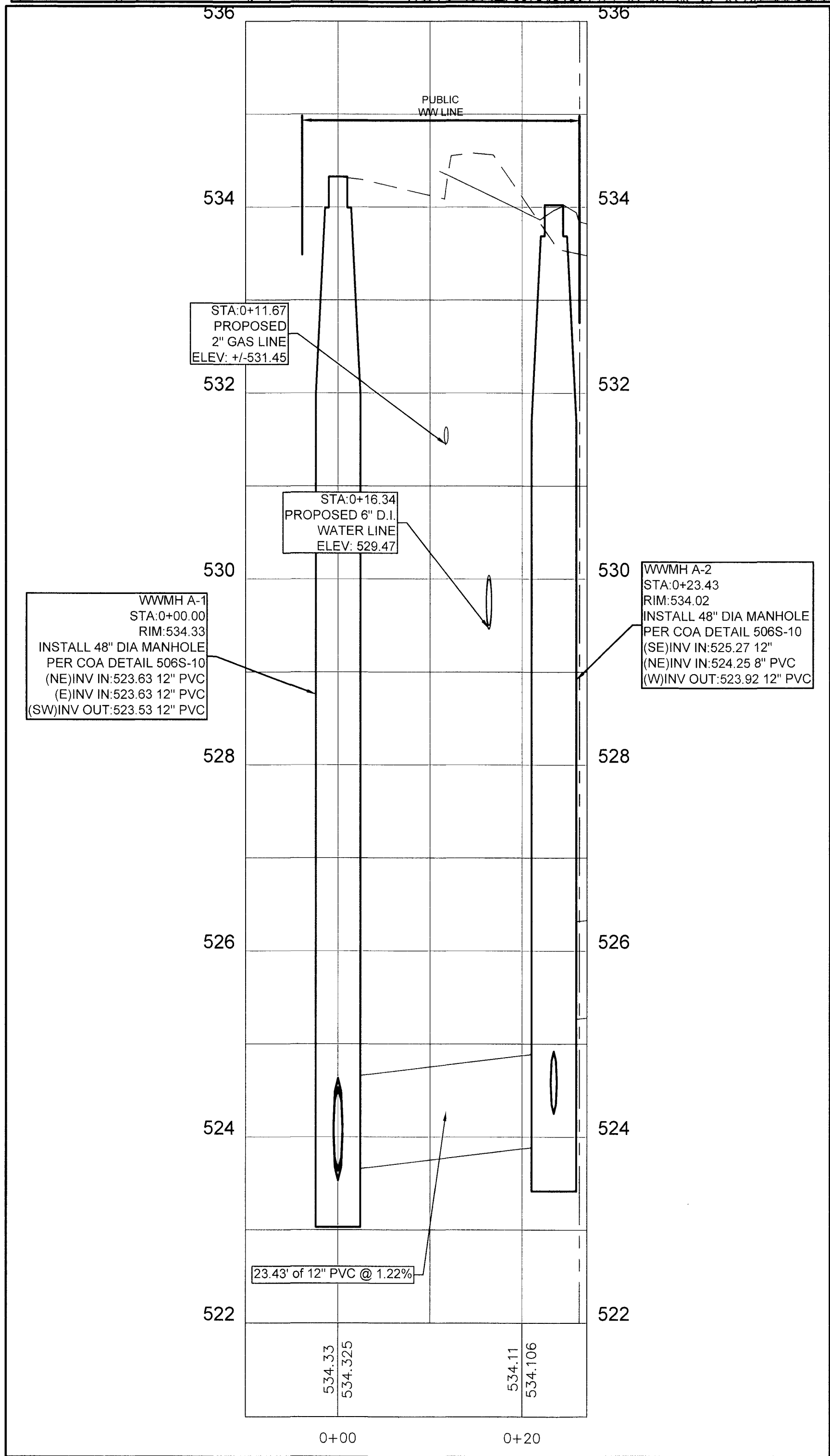
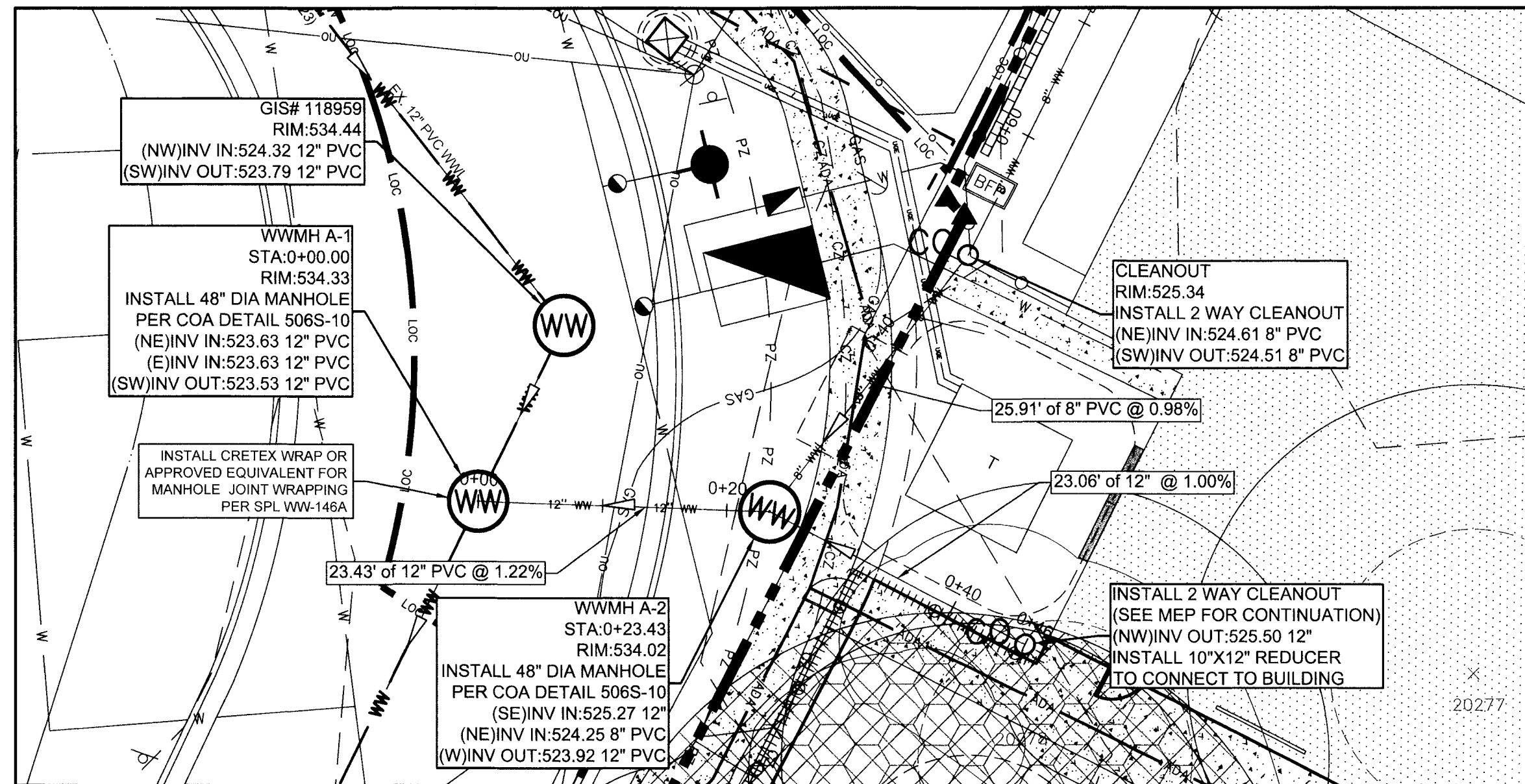

010'20'40'

LEGEND

BOUNDARY / RIGHT OF WAY

EASEMENT / SETBACK

CURB / EDGE OF PAVEMENT

EXIST. GRADE ELEVATIONS

PROP. GRADE ELEVATIONS

STORM DRAIN LINE

RETAINING / SCREEN WALL

WATER LINE

WASTEWATER LINE

OVERHEAD UTILITY LINE

UNDERGROUND ELECTRIC

GAS LINE

DIRECTION OF FLOW

PLANTING ZONE

PLANTING ZONE

CLEAR ZONE

TREE W/ TAG (TO REMAIN)

NOTES:

- CONTRACTOR SHALL FURNISH AND INSTALL ALL MATERIALS AND APPURTENANCES AS CALLED OUT ON PLANS.
- ALL PUBLIC POTABLE WATER PIPE (WITHIN R.O.W. AND UTILITY EASEMENTS) TO BE DUCTILE IRON CLASS 350 FOR PIPE 12-INCH IN DIAMETER AND SMALLER, AND CLASS 250 MIN. FOR PIPES GREATER THAN 12-INCH DIAMETER. FIRE HYDRANT LEADS TO BE DUCTILE IRON CLASS 350 PER DETAIL. SERVICE LEADS TO BE TYPE K COPPER PER DETAIL.
- ALL VERTICAL AND HORIZONTAL WATER LINE BENDS SHALL BE RESTRAINED TO THE MAIN USING MECHANICAL JOINT RESTRAINT DEVICES SUCH AS MEGA-LUG OR APPROVED EQUAL (SPL-WW-27A).
- FILL, COMPACT & TEST GROUND AT PROPOSED FINISHED GRADE ELEVATION TO 95% DENSITY PRIOR TO UTILITY CONSTRUCTION.
- REPAIR ASPHALT AS REQUIRED FOR INSTALLATION OF WATER & WASTEWATER LINES PER C.O.A. DETAIL 1100S-2. REFERENCE CONSTRUCTION DETAILS.
- NO COMBUSTIBLE CONSTRUCTION SHALL BEGIN ON THIS PROJECT SITE UNTIL ADEQUATE FIRE FLOW IS AVAILABLE.
- EXISTING SERVICE LINE LOCATIONS ARE APPROXIMATE AND NEED TO BE FIELD VERIFIED.
- LIMITS OF CONSTRUCTION ARE SHOWN ON EROSION & SEDIMENTATION CONTROL PLANS.
- ON ALL GRAVITY LINES, CONTRACTOR MUST START AT DOWNSTREAM END AND PROCEED UPSTREAM TAKING CARE TO EXPOSE ALL EXISTING UTILITIES AND STRUCTURES WHICH MAY CONFLICT WITH THE PROPOSED LINE. ANY OTHER SEQUENCE OF CONSTRUCTION WILL BE AT OWNERS RISK.
- ALL GRAVITY WASTEWATER PIPE TO BE PVC SDR-26 (GREEN).
- LOTS WITH 65 PSI OR GREATER REQUIRE A PRV, SET AT 65 PSI, TO BE INSTALLED ON THE OWNERS SIDE OF THE WATER METER.
- UNDERGROUND MAINS FEEDING PRIVATE FIRE HYDRANTS MUST BE INSTALLED AND TESTED IN ACCORDANCE WITH NFPA 24, AND THE FIRE CODE, BY A LICENSED CONTRACTOR WITH A PLUMBING PERMIT. THE ENTIRE MAIN MUST BE HYDROSTATICALLY TESTED AT ONE TIME, UNLESS ISOLATION VALVES ARE PROVIDED BETWEEN TESTED SECTIONS.
- REFERENCE GENERAL NOTES SHEET(S) FOR ADDITIONAL UTILITY NOTES.

SITE PLAN APPROVAL

Sheet 40 of 87

FILE NUMBER SP-2018-0296C APPLICATION DATE JULY 2, 2018

APPROVED BY COMMISSION ON N/A UNDER SECTION 112 OF CHAPTER 25-5 OF THE CITY OF AUSTIN CODE

EXPIRATION DATE (25-5-81, LDC) 12/6/22 CASE MANAGER ROSEMARY AVILA

Director, Development Services Department

RELEASED FOR GENERAL COMPLIANCE: 12/6/19 ZONING CS-V

Rev. 1 Correction 1

Rev. 2 Correction 2

Rev. 3 Correction 3

Final plat must be recorded by the Project Expiration Date, if applicable. Subsequent Site Plans which do not comply with the Code current at the time of filing, and all required Building Permits and/or a notice of construction (if a building permit is not required), must also be approved prior to the Project Expiration Date.

WWW.BIGREDDOG.COM
TEXAS REG. NO. F-15085

512.669.5560

BIG RED DOG
a division of MWGI

ENGINEERING | CONSULTING
2021 E. 5TH ST. #200
AUSTIN, TEXAS 78702

STATE OF TEXAS
VITO M. TRUPIANO
119592
LICENSED PROFESSIONAL ENGINEER

AUSTIN SOUTH LAMAR APARTMENTS
1515 SOUTH LAMAR
AUSTIN, TRAVIS COUNTY, TEXAS

WASTE WATER PLAN & PROFILE

SHEET

CU201

40 OF 87

SP-2018-0296C