

THE LOCATION OF EXISTING UNDERGROUND UTILITIES ARE SHOWN IN AN APPROXIMATE WAY ONLY. THE CONTRACTOR SHALL DETERMINE THE EXACT LOCATION OF ALL EXISTING UTILITIES BEFORE COMMENCING WORK. HE AGREES TO BE FULLY RESPONSIBLE FOR ANY AND ALL DAMAGES WHICH MIGHT BE OCCASIONED BY HIS FAILURE TO EXACTLY LOCATE AND PRESERVE ANY AND ALL UNDERGROUND UTILITIES.

ZILKER STUDIOS
1508 SOUTH LAMAR BOULEVARD, AUSTIN, TX 78704

LANDSCAPE PLAN - LEVEL 2



5110 LANCASTER COURT AUSTIN, TX 78723 FIRM REG # F12469
PHONE 512 761 6161 FAX 512 761 6167 INFO@CIVILTUDE.COM

SCALE: 1" = 10'-0"

JOB NO: _____
DGN BY: _____
DWN BY: _____
RWV BY: _____

SITE PLAN APPROVAL SHEET 19 OF 23
FILE NUMBER: **SP-2020-0246C.SH** APPLICATION DATE: **JUNE 12, 2020**
APPROVED BY COMMISSION ON _____ UNDER SECTION **112** ON
CHAPTER **25-5** OF THE CITY OF AUSTIN CODE
EXPIRATION DATE (25-5-01, LDC): _____ CASE MANAGER **CLARISSA DAVIS**
PROJECT EXPIRATION DATE (ORD #970905-A) _____ DWPZ _____ DDZ _____

Director, Development Service Department _____ ZONING: **CS-V, GR-V**
RELEASED FOR GENERAL COMPLIANCE: _____
Rev. 1 _____ Correction 1 _____
Rev. 2 _____ Correction 2 _____
Rev. 3 _____ Correction 3 _____

Final plan must be recorded by the Project Expiration Date, if applicable. Subsequent Site Plans which do not comply with the Code current at the time of filing, and all required Building Permits and/or a notice of construction of a Building permit is not required, must also be approved prior to the Project Expiration Date.
SHEET NO. **19** OF 23
Date: 07/22/2021

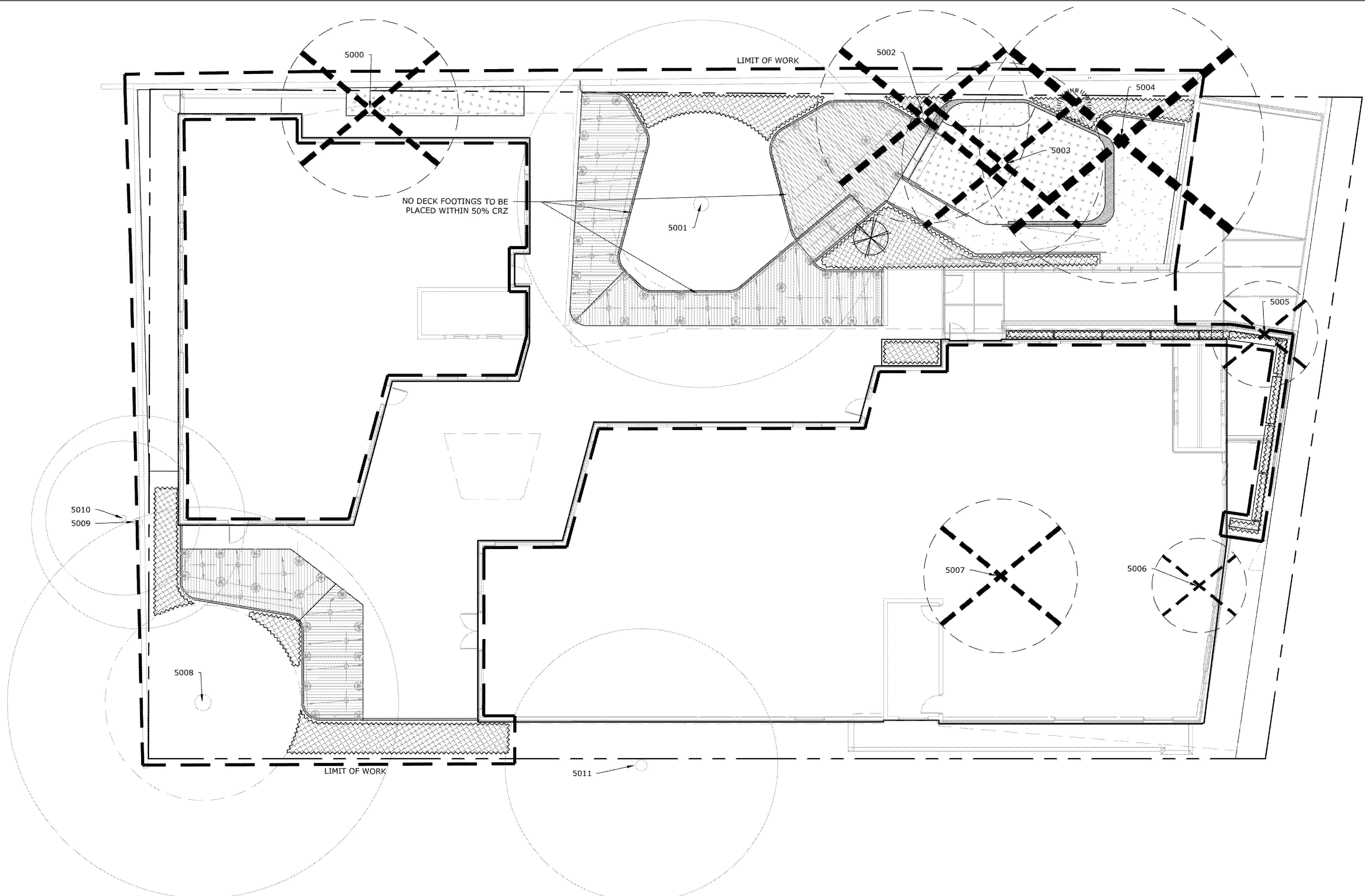

1 LANDSCAPE PLAN - LEVEL 2
SCALE: 1" = 10'-0"

LEGEND

- | | |
|--|--------------------------------|
| LIMIT OF WORK | TREE TO BE REMOVED |
| PROPERTY LINE | OFFSITE TREE TO REMAIN |
| R.O.W. DEDICATION | ANACACHO ORCHID 1.5" CAL. |
| TREX DECKING | SWEET ALMOND VERBENA 1.5" CAL. |
| ARTIFICIAL TURF | PLANTING AREA |
| EXISTING TREE TO REMAIN 50% OF CRZ SHOWN | |

NOTE:
THE AREA WITHIN THE 50% CRZ OF ALL PRESERVED TREES SHALL BE MULCHED AND NATURAL GRADE.

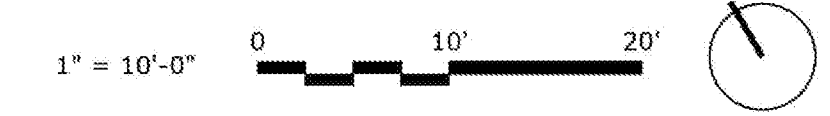

- EXISTING LEGEND
- HYDRANT W/ GATE VALVE
 - WATERLINE W/ GATE VALVE
 - WASTEWATER W/ MANHOLE
 - WASTEWATER W/ CLEANOUT
 - STORMLINE W/ MANHOLE
 - STORMLINE W/ CURB INLET
 - GROUND CONTOUR
- PROPOSED LEGEND
- HYDRANT W/ GATE VALVE
 - WATERLINE W/ GATE VALVE
 - WASTEWATER W/ MANHOLE
 - WASTEWATER W/ CLEANOUT
 - STORMLINE W/ MANHOLE
 - STORMLINE W/ CURB INLET
 - GROUND CONTOUR
 - ELECTRIC LINE
 - GAS LINE
 - ACCESSIBLE ROUTE
 - FIRE LANE
 - CONCRETE WALL
 - TRADITIONAL CONCRETE

